

■ ADVANTAGE

- Wattage switchable :
30W/35W/40W (2x2ft)
45W/50W/55W (2x4ft)
- CCT switchable: 3500K/4000K/5000K
- 0-10v dimmable
- PF>0.90 , CRI>80
- Input voltage: AC120-277V
- Lumen : 125LM/W
- Application: corridor, office , school, library, etc

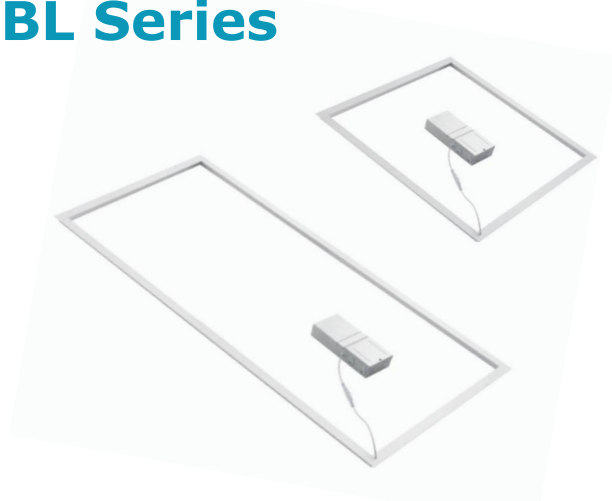

■ DETAILS

Features

- Slim and modern design.
- Aluminum material frame better heat dissipation.
- High efficiency isolated led driver with dimmable function.
- Wattage and CCT switchable through dip-switches.
- Excellent thermal management system.
- Unique design to save packing space.

Accessories

- Emergency battery ,motion sensor, suspended chains for option.

Certifications

- DLC premium.
- Comply with the requirements of the Standard(s) for Luminaires and are identified with the cETL Listed Mark.

Warranty

- All products from DIMI LIGHT are guaranteed with 5 years' warranty.
- See Warranty policy from Dimi light for additional information.

■ DIMENSIONS

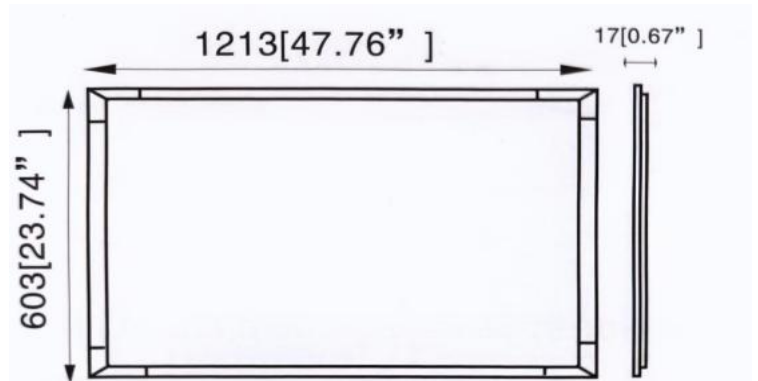
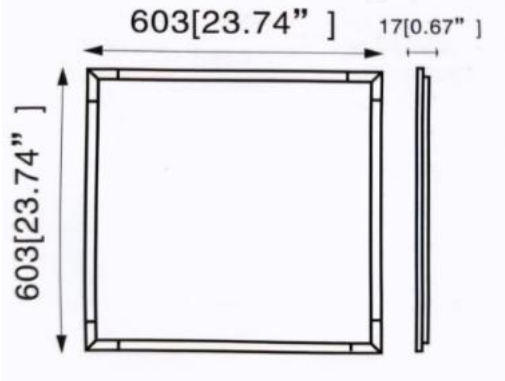

| SIZE | Length(inch) | Width (inch) | Height(inch) |
|-------|--------------|--------------|--------------|
| 2x2ft | 23.74" | 23.74" | 0.67" |
| 2x4ft | 47.76" | 23.74" | 0.67" |

■ SPECIFICATION

| | MODEL | SIZE | WATT | CCT | EFFICACY |
|--------------------------|-------------------|-------|---------------------------|---------------------------------|----------|
| <input type="checkbox"/> | DM-TB2240WT-3545K | 2x2ft | 30W/35W/40W switchable | 3500K/4000K/5000K switchable | 125Lm/W |
| <input type="checkbox"/> | DM-TB2455WT-3545K | 2x4ft | 45W/50W/55W switchable | 3500K/4000K/5000K switchable | 125Lm/W |

■ ACCESSORY



Suspension Kit

- For suspending the T-bar Light
- Material: stainless steel

■ INSTALLATIONS

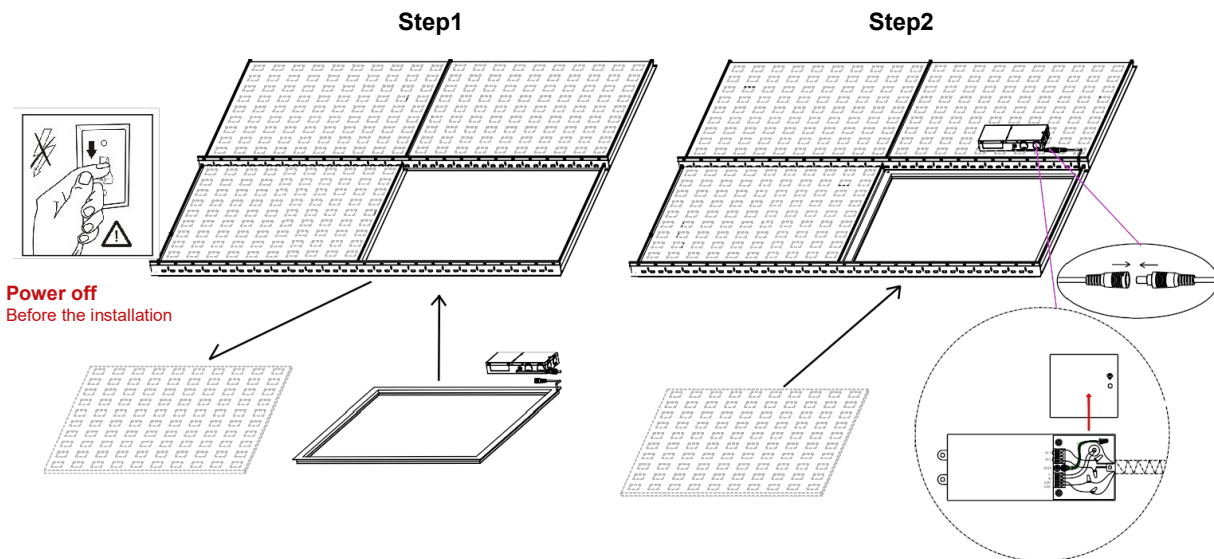

- Step 1:** Make sure of all the power is off before installing. Remove the one ceiling tile that you need to install light fixture on. Then place the light fixture on the T-bar carefully and make sure it is correctly in place and secure.
- Step 2:** Place the driver on top of the next ceiling tile. Connect the cable between the driver and the lighting fixture.
- Step 3:** Open the driver's junction box and connect the AC wire to the driver correctly (L=black & N=white).

■ PACKING INFO

| SIZE | 10PCS/CARTON | | | CONTAINER | | |
|-------|---------------------|----------|----------|------------|------------|-----------|
| | DIMENSION(INCH) | N.W(LBS) | G.W(LBS) | 20'GP(PCS) | 40'GP(PCS) | 40HQ(PCS) |
| 2x2ft | 25.22"x10.5"x10.23" | 13.32 | 15.65 | 6020 | 12470 | 15,000 |
| 2x4ft | 43.34"x10.5"x10.23" | 20.28 | 24.91 | 3500 | 7250 | 8800 |

■ PHOTOMETRIC DATA

DM-TB2240WT-3545K

| | |
|---------------|----------|
| Minimum Watt | 30W |
| Maximum Watt | 40W |
| PF | 0.982 |
| CRI | 84 |
| THD | 11.8% |
| Lumen | 5000 Lm |
| Efficacy (AC) | 125 Lm/W |
| Minimum CCT | 3500K |
| Maximum CCT | 5000K |
| Voltage Range | 100-277V |

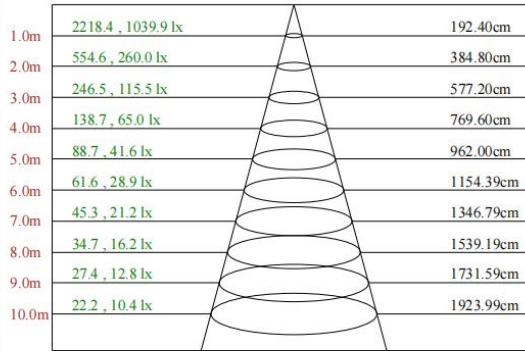

Max , Ave Beam angle of C112.5 plane 87.78

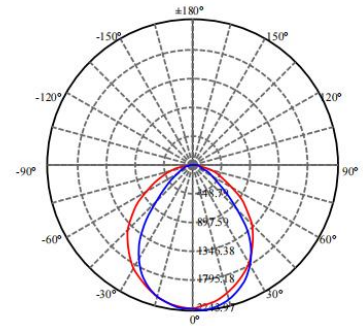

DM-TB2455WT-3545K

| | |
|---------------|----------|
| Minimum Watt | 30W |
| Maximum Watt | 40W |
| PF | 0.982 |
| CRI | 84 |
| THD | 11.8% |
| Lumen | 5000 Lm |
| Efficacy (AC) | 125 Lm/W |
| Minimum CCT | 3500K |
| Maximum CCT | 5000K |
| Voltage Range | 100-277V |

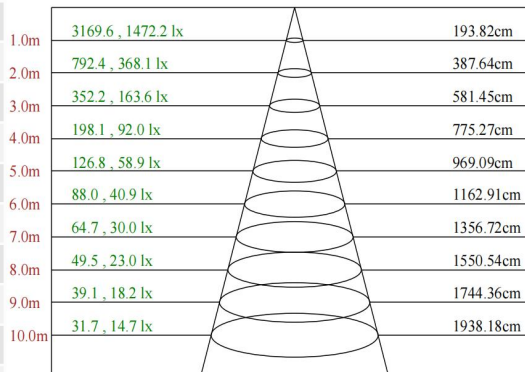

Max , Ave Beam angle of C112.5 plane 88.20

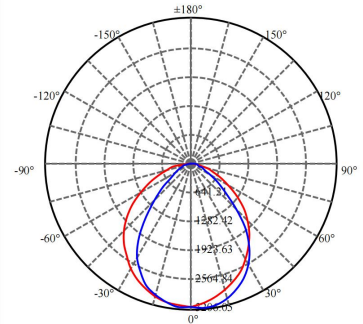

■ APPLICATIONS

